

File Ref/Case Officer:EM30/06/210/001 J. Davis

**EXERCISE OF DELEGATED POWERS**

**Title :** **WAYLEAVE – BALTIC BUSINESS QUARTER, ABBOT’S HILL**

Gateshead Council Constitution (13th Edition – July 2016)  
Schedule 5 - Executive Functions Delegated to Managers.  
Part 1 – Delegations to Individual Managers.  
4. Strategic Director, Corporate Services & Governance  
Service Director, Legal, Democratic and Property Services

Statutory Power – In granting the wayleave the Council is exercising the power contained in section 123 of the Local Government Act 1972

(2) To deal with applications for easements and wayleaves affecting Council owned premises not materially affecting the use to which they are or might be put where the full value of the consideration does not exceed £10,000

**Policy :** Vision 2030

**Proposal :** Installation of jointing chamber and underground duct with associated cables

**Premises :** Land at Baltic Business Quarter, Abbot’s Hill

**Grantee :** British Telecommunications plc



**Premium :** Nil

**Term :** Until notice is served by either party

**Use :** Underground Cables

**Main Terms :**

**Comments :**

Surveyor		Team Leader		Property Manager	
----------	---	-------------	--	------------------	---

**Approved By :**  Date 1/6/17  
 pp. M. Harrison  
 Service Director, Legal Democratic & Property Services

# Legend

## CAUTION AREA

BT.CAUTION\_AREA

## EQUIPMENT

- FIBRE, TCODE
- COPPER, CABINET
- COPPER, DP

## DUCT

- AERIAL
- TUNNEL
- DUCT

## PROPOSED

- AERIAL
- DUCT

## STRUCTURE

- YCODE
- CABINET SHELL
- SPLIT COUPLING
- POLE
- KIOSKS
- MANHOLE
- JOINTBOX
- CHANGE OF STATE
- DUCT TEE

## PROPOSED

- MANHOLE
- JOINTBOX
- DUCT TEE

Other proposed plant is shown as hatched lines.

BT symbols not listed above may be disregarded.

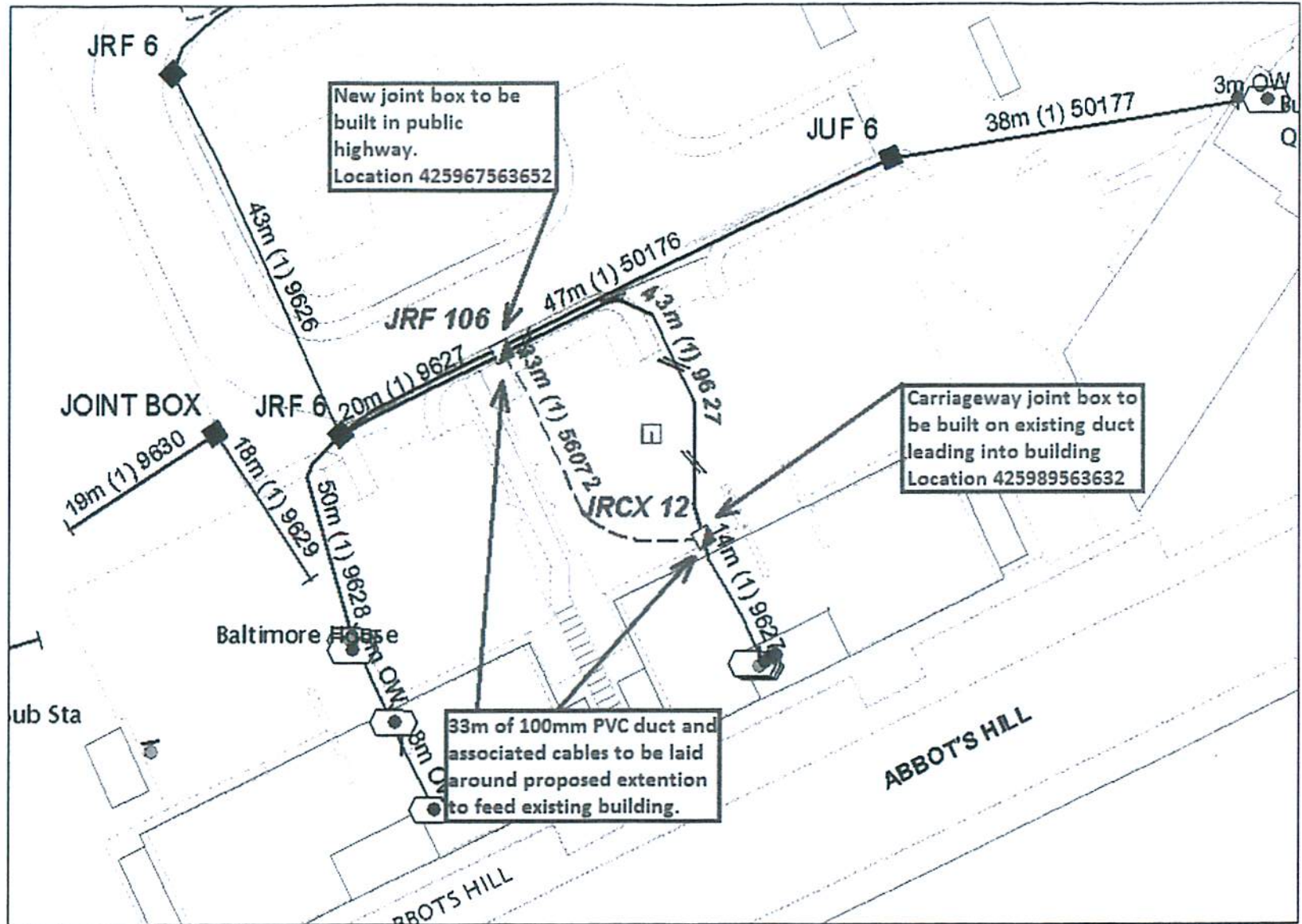

**IMPORTANT WARNING:**  
Information regarding the location of BT apparatus is given for your assistance and is intended for general guidance only. It does not constitute a guarantee of accuracy. It should not be relied upon in the event of an emergency or when work being made near to BT apparatus, which may exist at various depths and may deviate from the marked route.

Existing BT plant may not be recorded. Information valid at time of preparation.  
FOR FURTHER LOCAL SERVICE MARKING SERVICE CALL THE EXCHANGE OPERATOR AND ASK FOR:  
FREEPHONE 0800 371000  
FAX 020 8000000  
NAT 0204 16215 FLS 0200 81000



### PLANT INFORMATION REPLY

Wayleave application

Open University Building, Abbot's Hill, Gateshead.

**openreach**  
BT Group business